

MP4 Pilot Göteborg

September 2009 - December 2009

As an input to one of the case studies an internal stakeholder group in September performed a two day study trip to Malmö. The group had the chance to visit projects and get interviews with responsible persons.

During the period the work with the sociotop map (S-map), co-operation with FLD and their E-map and the work with the park district plans for Gunnared and Lärjedalen has continued.

Lövgärdet skiss 2009-11-09

Sjungenstråken - "Korta rundan" påribband av små platser längs
Platserna - Rävlyan, Kyrkplatsen och Badet
Ihophållet med tema, ex. trädgård och skog

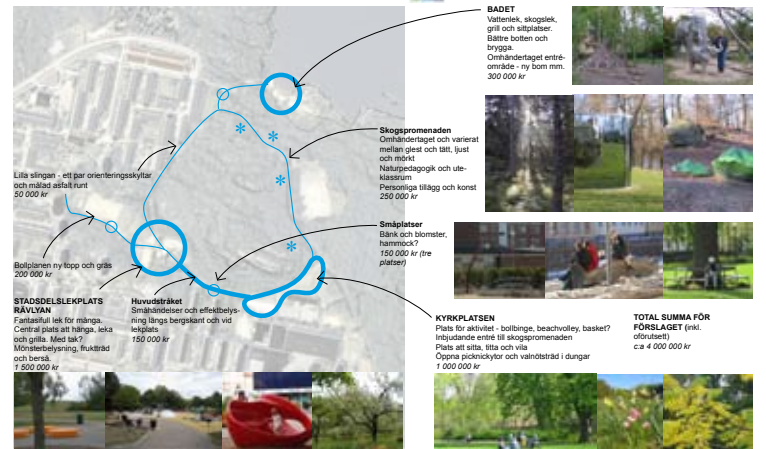

Development of the park in Lövgärdet - draft, Nov 2009

An agreement has been made on co-financing the refurbishment of the park in Lövgärdet.

The two local housing companies and the Gunnared city district Adm. have decided to join the project. Their financial contributions will almost double the total investments in the park.

In December 2009 a detailed planning and scheduling of the investments is about to start.



Study trip to case study "Theme playgrounds in Malmö". On site presentation with the City of Malmö staff, Sep 2009



Joint planning workshop Bruges, Dec 2009

